

4

3

2

1

B

B

A

A

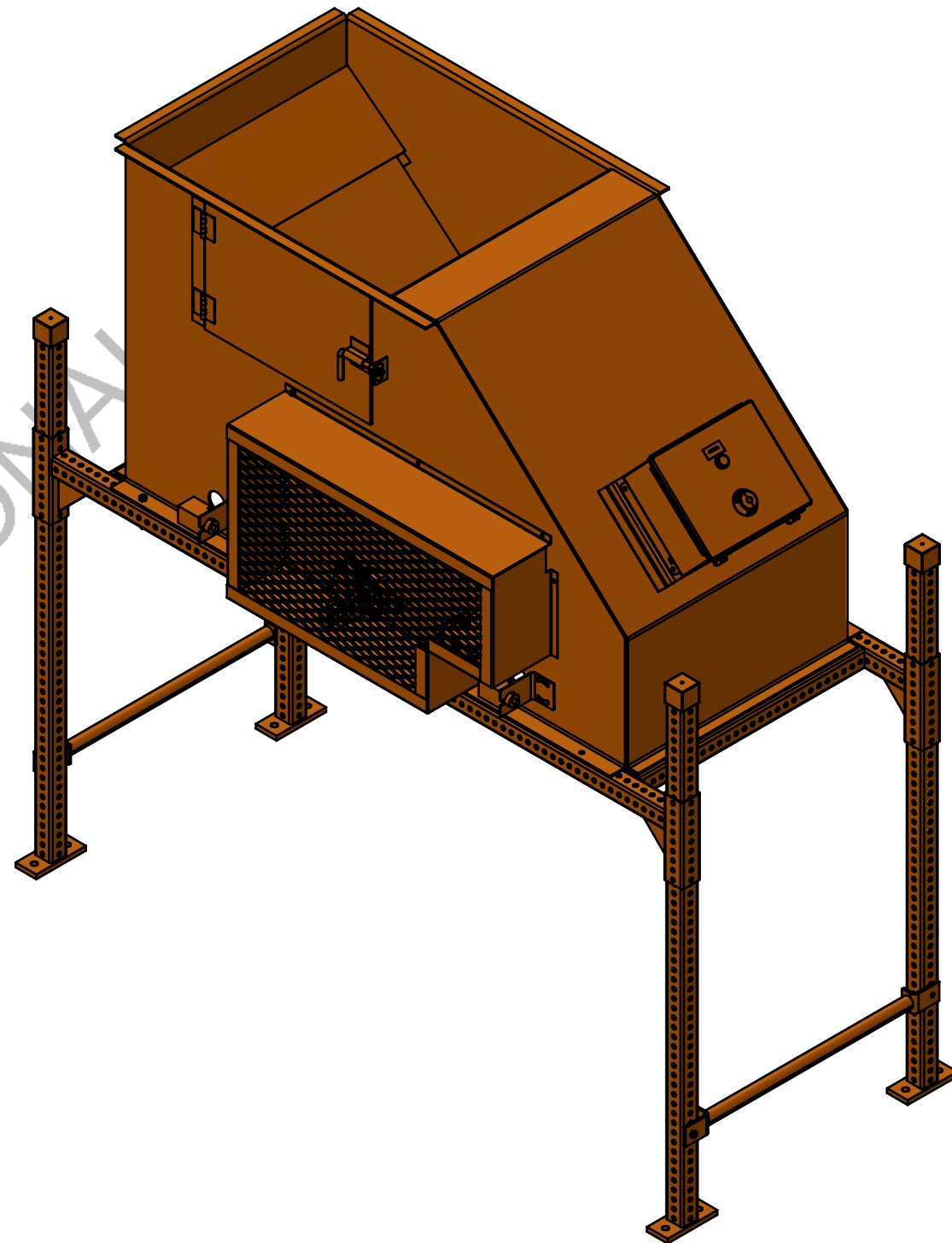
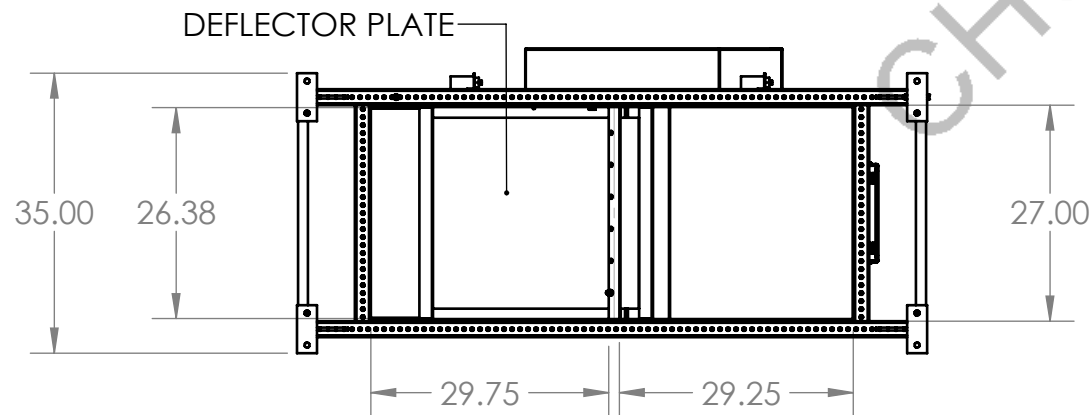
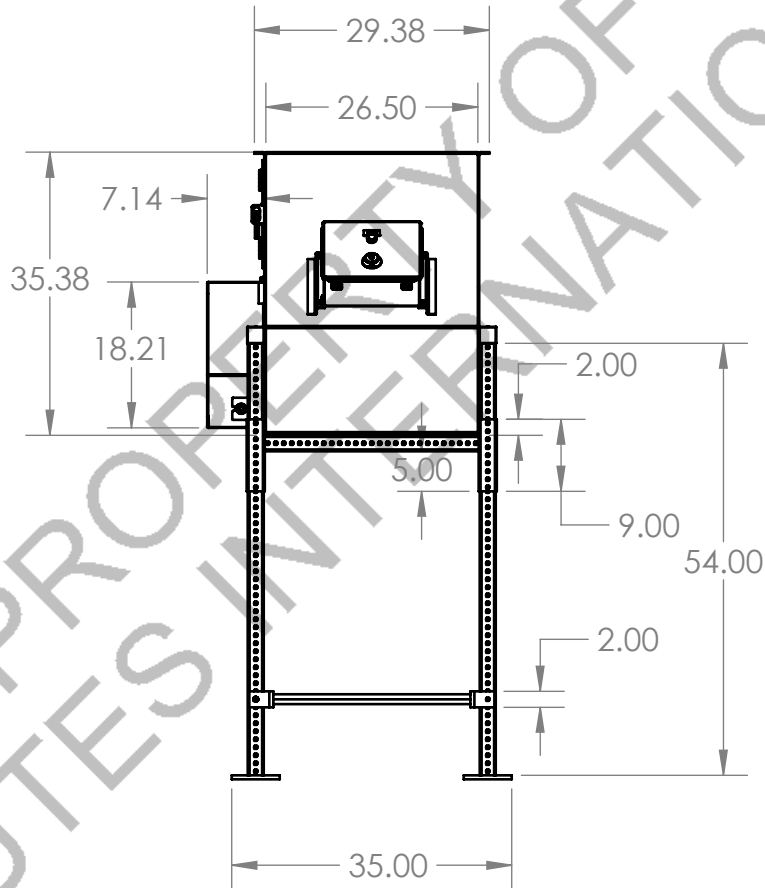
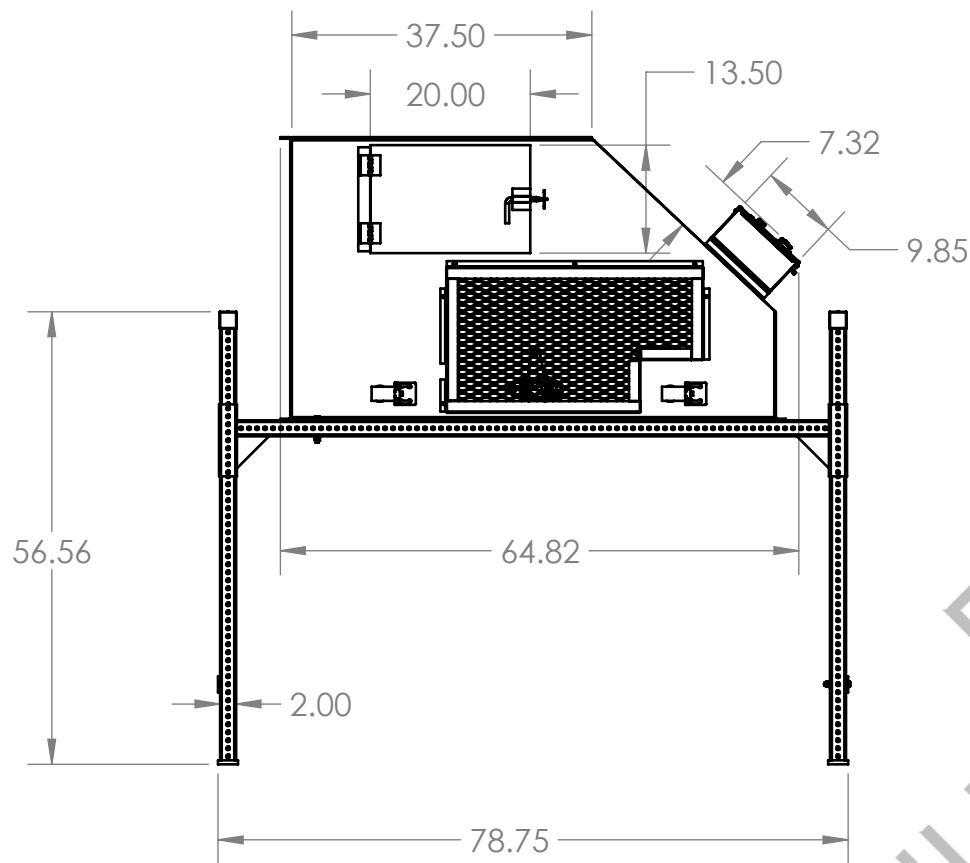
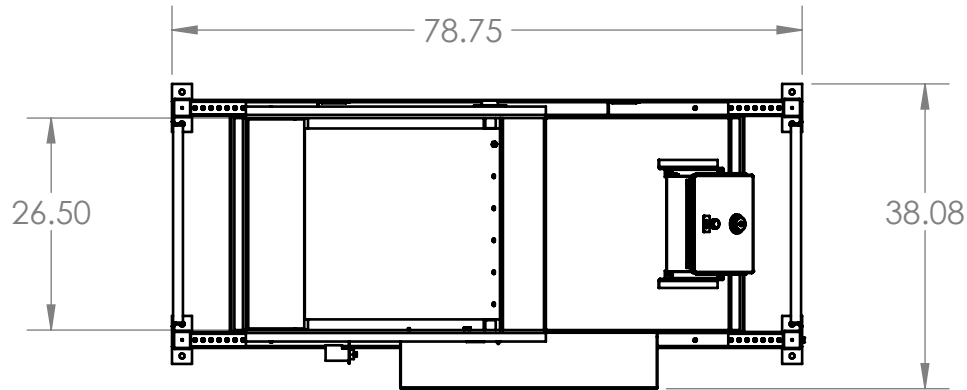

UNLESS OTHERWISE SPECIFIED:		NAME	DATE	<div>CHUTES</div> <div>PATENTED CHUTES INTERNATIONAL™</div> <div>33 Industrial Park Dr. Waldorf, MD 20602 Phone: (240) 448-5000 Fax: (301) 753-4108 WWW.CHUTES.COM</div>	
DIMENSIONS ARE IN INCHES		DRAWN	KASSIE 08/08/2022		
TOLERANCES:		CHECKED	ENG'G		
FRACTIONAL ± 1/16 ANGULAR: MACH±1° BEND ±1° BEND-LINE PLACMENT ±0.010 THREE PLACE DECIMAL ±0.100 WELD THICKNESS + 1/16		MFG APPR.	MFG'G		
SHEET METAL SPECIFICATIONS		<div>PROPRIETARY AND CONFIDENTIAL</div> <div>THE INFORMATION CONTAINED IN THIS DRAWING IS THE SOLE PROPERTY OF CHUTES INTERNATIONAL MANUFACTURING.</div> <div>ANY REPRODUCTION IN PART OR AS A WHOLE WITHOUT THE WRITTEN PERMISSION OF CHUTES INTERNATIONAL MANUFACTURING IS PROHIBITED. PRODUCT IS SUBJECT TO OUR CONTINUOUS IMPROVEMENT PROGRAM AND WE RESERVE THE RIGHT TO IMPLEMENT CHANGES AND IMPROVEMENTS TO THE PRODUCTS SHOWN HEREIN WITHOUT PRIOR NOTICE.</div>		DESCRIPTION:	
COMMENTS:				<div>DS130-BI BISORTER</div>	
		SIZE	PART ID:		REV
		B	BISORTER		A
		DO NOT SCALE DRAWING		SCALE: 1:24	SHEET 1 OF 1